

Other models in this range:
 MV306 - MV426 - MV430
 MV456 - MV460
 MV806 - MV1006

MV Cube Ice Machines up to 320 Kg



MV 606 with SB393 (sold separately)



MV606+SB393
(sold separately)



MV606+SB530
(sold separately)



MV606+SB948+KBTMVB948
(sold separately)



MV606+SB1025
(sold separately)

Standard Features

- **"Global Standard" width-** 30" (76.20 cm) wide
- **Auto-Alert indicator lights-** communicate about operating status: a diagnostic LED light guides the troubleshooting process and helps decisions regarding opening a service call.
- **Front-facing Evaporator-** Ice forming process inspection and routine cleaning operations may be accomplished simply removing the front panel.
- **Hand-removable water distribution tube-** routine cleaning has never been so easy!
- **Embedded antimicrobial-** Ag-Ion® antimicrobial is present in selected food-zone components
- **External Components-** All external panel components are crafted for optimal aesthetic appeal through superior fit and finish
- **Reusable air filter** is easily removable from the outside for ease of cleaning (in air-cooled models)
- **California Energy Commission-** meets or exceeds CEC guidelines

MV606 Technologies

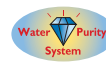

		24h						
		21°: 15°C	32°: 21°C					
		[kg]	[lbs]	N°	N°*	[WxDxH mm]	[WxDxH inches]	
MV606 AS		280	617	29000	215	474		21500
MV606 WS		275	606	27500	240	529	24000	2915/16" x 247/16" x 2210/16"
MVH606 AS		290	639	48140	215	474	35690	
MVH606 WS		275	606	45650	240	529	39840	
						 [v/Hz/ph]	 R 404 a	

This product qualifies for the following listings:



Medium Cube - 10 g
 W 23 x D 23 x H 26 mm



Small Cube - 6 g
 W 11 x D 23 x H 26 mm

2 Years Warranty

Subject to certain limitations and exclusions

Certified ISO 9001:2000

www.scotsman-ice.it
www.scotsman-ice.com
www.scotsman-ice-on-tablet.com

Models and specifications are subject to change without notice.

9/2012

Other models in this range:
 MV306 - MV426 - MV430
 MV456 - MV460
 MV806 - MV1006

MV Cube Ice Machines up to 320 Kg

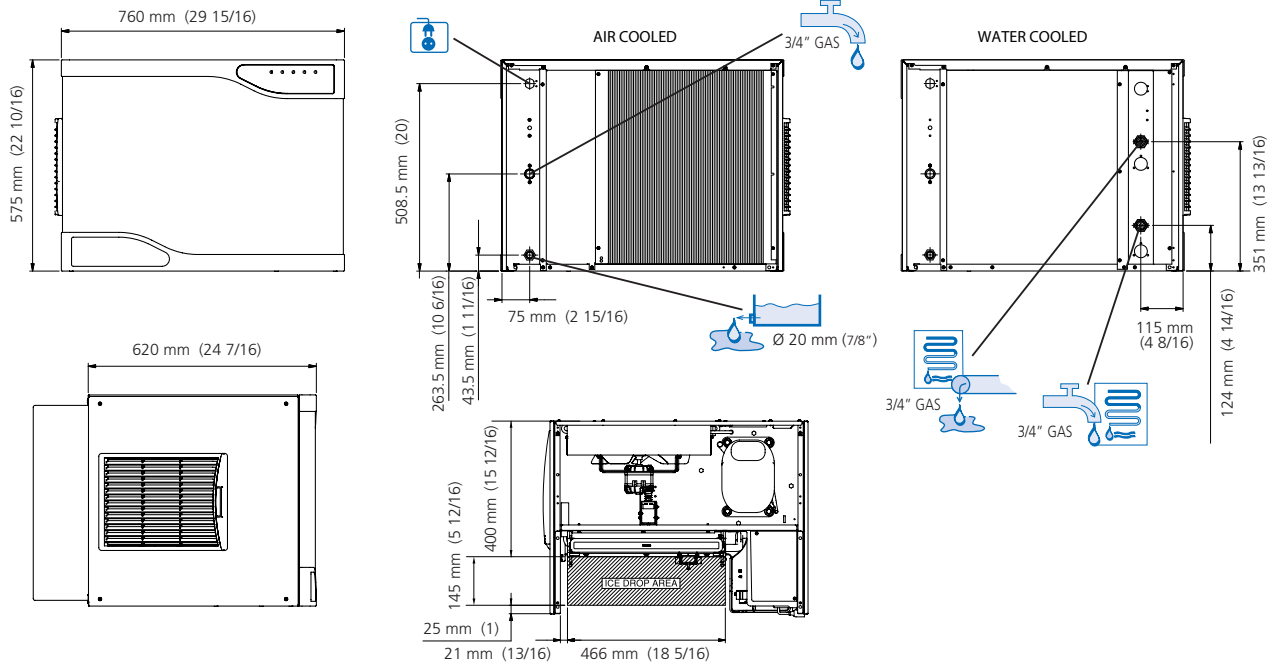

MV606 AIR COOLED

°C °F	°C				kg
	50° 10°	60° 15°	70° 21°	90° 32°	
10°	320	305	285	250	kg
50°	705	672	628	551	lbs
21°	290	280	265	235	kg
70°	639	617	584	518	lbs
32°	225	220	215	195	kg
90°	496	485	474	430	lbs
38°	192	189	185	175	kg
100	423	417	408	386	lbs



MV606 WATER COOLED

°C °F	°C				kg
	50° 10°	60° 15°	70° 21°	90° 32°	
10°	285	280	275	253	kg
50°	628	617	606	558	lbs
21°	275	270	265	245	kg
70°	606	595	584	540	lbs
32°	250	245	240	220	kg
90°	551	540	529	485	lbs
38°	245	240	235	215	kg
100	540	529	518	474	lbs



Minimum		Maximum	
10°C (50°F)	5°C (41°F)	40°C (104°F)	35°C (95°F)
-10%	1 BAR 14 psi	+10%	5 BAR 70 psi

	Icon	Icon	Icon	Icon	Icon	Icon	Icon	Icon	Icon	Icon								
	[l/h]	[gal/h]	[kg]	[lbs]	[kg]	[lbs]	[kg]	[lbs]	[kg]	[lbs]								
MV606.AS	14,5	3,8	71	157	86	190	13150	3860	3x1,5	1300	16 A	13	137	36,2	71	157	86	190
MV606.WS	137	36,2	71	157	86	190	13150	3860	3x1,5	1050	16 A	9,6	14,5	3,8	71	157	86	190
MVH606.AS	14,5	3,8	71	157	86	190	13150	3860	3x1,5	1300	16 A	13	137	36,2	71	157	86	190
MVH606.WS	137	36,2	71	157	86	190	13150	3860	3x1,5	1050	16 A	9,6	14,5	36,2	71	157	86	190

CONTACT POINTS:

Europe
 Scotsman Europe-Frimont S.p.A.
 Ph/Fax +39-0293960208 / 0293960201
 scotsman.europe@frimont.it
 Paolo Moro

Middle East & N. Africa
 Scotsman-Frimont Regional Office (MEnA)
 Ph/Fax +97-16 5262944 / 165262946
 m.dawood@frimont.ae
 fernando.m@frimont.ae

Asia and Pacific
 Scotsman Industries (S) PTE. L.T.D.
 Ph/Fax +65-67385393 / 67381959
 scotsman@scotsman.com.sg
 Andrea Tronci

South Africa
 Scotsman SA (Pty) Ltd - Ice Systems (Pty) Ltd
 Ph +27-0105900609 / 0877200245/6/7/8
 Fax: +27-118264123 / 0866340803
 stuart@scotsmansa.co.za - jennifer@scotsman.co.za

India
 Scotsman Group India
 Ph/Fax: +91-1244002459 / direct 9560072459
 david.owen@scotsman.com.sg

Spain
 Scotsman España, S.L.U. c/ Galapagar, 12
 Ph/Fax +34-911109796 / 916337423
 scotsman@scotsman-espana.es
 Daniel Doblado

China
 Scotsman Ice Systems (Shanghai)
 Ph/Fax: +86-2161313200 / 2161313330
 scotsman.shanghai@scotsman-china.com
 Andrew Clayton